



STARLITE® Installation Methodology

HANDLING AND STORAGE

- Store undercover and in dry conditions.
- Handle with care, especially on the edges and corners, which can be damaged if subject to sharp impact.
- Do not apply excessive pressure, for example by standing or sitting on the product, as permanent damage may be caused.
- **NB:** STARLITE should not be installed in applications where the facing material is exposed to direct or indirect Ultraviolet radiation.

TOOLS

- Sharp Knife
- G-clamps
- Galvanised hoop irons
- Pop-rivets
- Drill
- Heavy-duty staple gun
- 10mm wire staples

1.

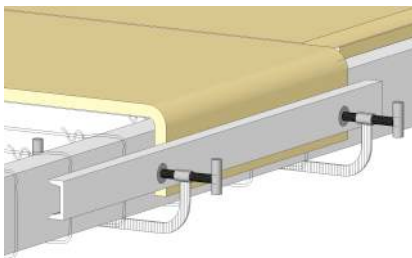

- Install straining wires at 300m centres.
- Using the G-clamp affix STARLITE roll at the apex.
- Unroll the blanket taking out any slack.

2.

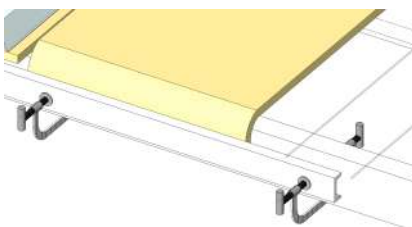

- Using the G-clamp affix STARLITE roll at the bottom purlin.

3.

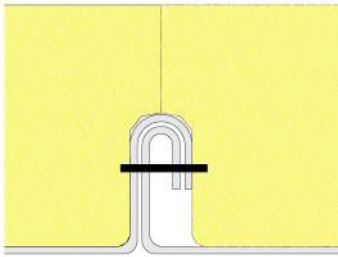

- To join the blankets fold-up the overlapping foil edges.
- Staple together.
- Fold the foil over and staple again.

4.

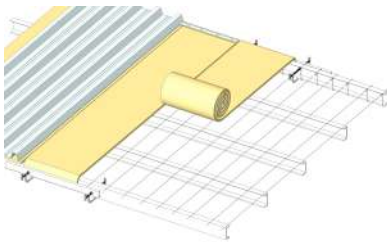

- Fix the roof sheeting to the purlins through the STARLITE
- Once in position, replace G-clamps to hold STARLITE in place

For insulation of 75mm, 100mm and 135mm thick, Insultrak type spacer blocks should be installed on top of purlin to allow for insulation recovery to nominal thickness. Please consult roof system manufacturer for spacer detail

5.

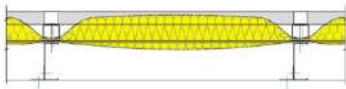

- The spacers allow STARLITE to “pillow out” between the purlins

NB: Quoted R-values are theoretical (See STARLITE Data Sheet) and may differ on site due to compression at the purlins once installed. Compression over purlin is still acceptable in terms of complying with SANS 204:2011. Insultrak type spacer systems are recommended to eliminate compression. Please consult your roof sheet manufacturer for more information in this regard.



TEL: (012) 800 3606

www.roofinsulation.co.za